

STATE	STATE FUNDING REFERENCE NO.	ROUTE NO.	TOTAL LENGTH
N.C.	11C.003013	1	12

STATE OF NORTH CAROLINA
DIVISION OF HIGHWAYS

ALLEGHANY COUNTY

LOCATION: SR 1310 DEACON RD. FROM THE INTERSECTION WITH SR 1311 STA. 10+00 TO END OF PROJECT STA. 60+50.68
TYPE OF WORK: GRADE, DRAIN, BASE, PAVE - 0.96 MILES

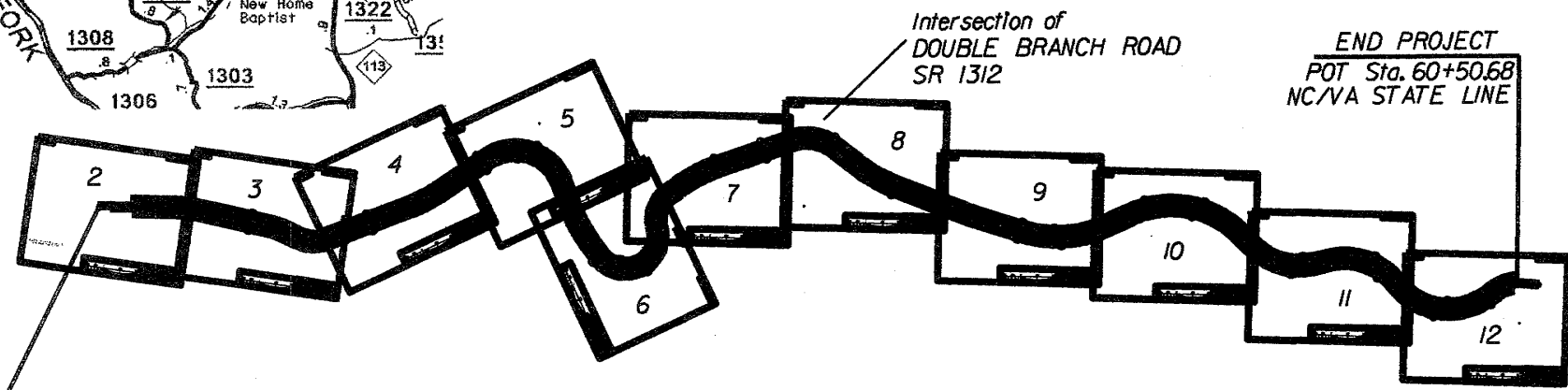
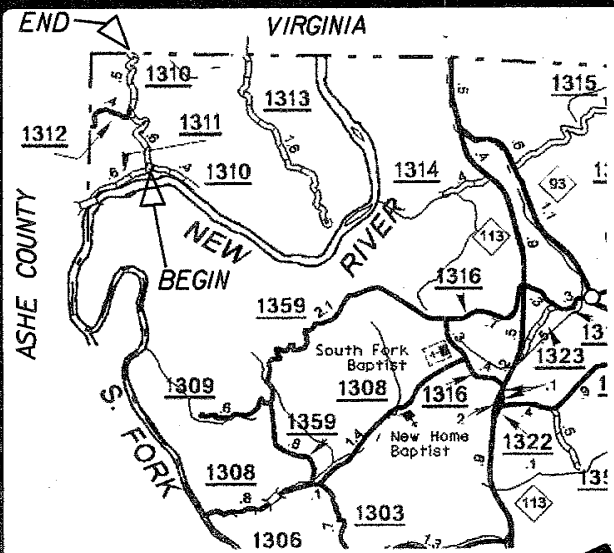

BEGIN PROJECT
POT Sta. 10+00.00
at PI of LEGRA RD. SR 1310
and DEACON RD. SR 1311

END PROJECT
POT Sta. 60+50.68
NC/VA STATE LINE

DISCLAIMER

THIS MAP IS NOT A CERTIFIED SURVEY AND HAS NOT BEEN REVIEWED BY A LOCAL GOVERNMENT AGENCY FOR COMPLIANCE WITH ANY APPLICABLE LAND DEVELOPMENT REGULATIONS. THE PROPERTY SHOWN ON THIS MAP WAS LOCATED FOR THE NORTH CAROLINA DEPARTMENT OF TRANSPORTATION FOR HIGHWAY DESIGN PURPOSES. SOME ERROR MAY EXIST BETWEEN THE GRAPHICAL AND ACTUAL GROUND LOCATIONS OF PROPERTY LINES. THIS MAP IS TO BE USED AS A GRAPHICAL REPRESENTATION OF THE NCDOT'S INTENT TO ACQUIRE PROPERTY FOR RIGHT OF WAY PURPOSES, AND IN NO WAY REPRESENTS AN ACTUAL BOUNDARY SURVEY OF THIS PROPERTY.

GRAPHIC SCALES	DESIGN DATA	PROJECT LENGTH 0.96 MILES	Prepared in the Office of DIVISION OF HIGHWAYS DIVISION 11, DISTRICT 1, ELKIN P.O. BOX 558 ELKIN, NC 28621		DIVISION ENGINEER	DIVISION OF HIGHWAYS STATE OF NORTH CAROLINA
			RIGHT OF WAY DATE: OCTOBER 22, 2009 LETTING DATE:	M.A. PETTYJOHN, P.E. DIVISION ENGINEER B.W. WHITAKER, P.E. DISTRICT ENGINEER	SIGNATURE: _____ P.E. DISTRICT ENGINEER	STATE DESIGN ENGINEER _____ P.E. DEPARTMENT OF TRANSPORTATION FEDERAL HIGHWAY ADMINISTRATION APPROVED _____ P.E. DIVISION ADMINISTRATOR DATE: _____

ALL BASIN'S 10'-20'
IN LENGTH REQUIRE
2 COIR FIBER BAFFLES.
BASIN'S LESS THAN 10'
REQUIRE ONLY 1
DESIGN BY: J. C. BRYANT 669

WATTLES MUST BE
USED IN CONJUNCTION
WITH PAM's
12" MIN. WATTLE
HEIGHT

ALL CROSS LINE PIPES
ARE TO BE INSTALLED
IN ACCORDANCE WITH
BMP 4.2

* HEADWALLS SHALL BE
INSTALLED ON CROSSLINE
PIPE AT STA. 11+79

Rip Rap should not be placed in the stream bed
or below high water mark unless permitted

END PROJECT -Y-
POT Sta. 39+31.87
Gabions to be placed left of project from Sta. 10+60 to Sta. 11+50
(clutter on plans prevent gabions from being visible)

BEGIN PROJECT -L-
POT Sta. 10+00.00

"DEACON ROAD"
SR 1311

-Y- PC Sta. 37+60.33
-Y- PT Sta. 38+73.64

BLOCK WELL HOUSE
9' x 3' x 3'
ID 2.C
E.I.P 12+46
12.47 RT
5.9 %

9' x 3' x 3'
ID 2.A

Proposed Pipe
18' x 45'
Sta. 10+14

3.1 %

81 ATA 1950
"PEDROS"
-Y-37+83
14.3'LT

SPECIAL SEDIMENT CONTROL
SPECIAL SEDIMENT CONTROL

UNNAMED TRIBUTARY
TO "NEW RIVER"

3.1 %
Proposed Arch
Pipe
75' x 55' x 55'
Sta. 11+79

PROPOSED
100' X 100'
SIGHT TRIANGLE

9' x 3' x 3'
ID 2.B

WOODEN
DECK
1 STORY
FRAME
DWELLING

PROPOSED 25' R/W
-Y-1 E.O.P.
STA. 11+00

PROPOSED 25' R/W
-Y-2 E.O.P.
STA. 11+00

INFO. TAKEN FROM
PROJECT "SR 1311"

"LEGRA ROAD"
SR 1310

NARCISO & MADIA
ITURRALDE
DB 294 PG 218

PC Sta. 12+16.05

WILLARD WINSTON ONLEY III
Deed Book: 229 Pg: 199



LOCATION:	SR 1311 "DEACON RD."
COUNTY:	ALLEGHANY
TOWNSHIP:	PINEY CREEK
DESIGNED BY:	JD WOOD
CHECKED BY:	CCA
DATE:	CCA

MATCHLINE SEE SHEET "3"

ALL BASIN'S 10'-20' IN LENGTH REQUIRE 2 COIR FIBER BAFFLES. BASIN'S LESS THAN 10' REQUIRE ONLY 1
DESIGN BY: J. C. BRYANT 669

ALL CROSS LINE PIPES ARE TO BE INSTALLED IN ACCORDANCE WITH BMP 4.2

WATTLES MUST BE USED IN CONJUNCTION WITH PAM'S

12" MIN. WATTLE HEIGHT

Rip Rap should not be placed in the stream bed or below high water mark unless permitted.

HEADWALLS SHALL BE INSTALLED ON CROSSLINE PIPE AT STA. 14+64

Gabions to be placed right of project from Sta. 14+70 to Sta. 15+70 (clutter on plans prevent gabions from being visible)

PI Sta 16+72.21
Δ = 46° 16' 55.5" (LT)
D = 57' 17" 44.8"
L = 80.78'
T = 42.74'
R = 100.00'

(2) PEDRO HERNANDEZ DB 131 PG 414

(5) PEDRO HERNANDEZ DB 131 PG 414

(6) PEDRO HERNANDEZ DB 131 PG 414

(7) PEDRO HERNANDEZ DB 131 PG 414

E.I.P. 13+63 12.91 LT

Proposed Arch Pipe 75' x 55' x 80' Sta. 14+64

9' x 3' x 3' ID 3.B

UNNAMED TRIBUTARY TO 'NEW RIVER'

E.I.P. 16+16 12.38 LT 8.0

9' x 3' x 3' ID 3.C

(3) PEDRO HERNANDEZ DB 131 PG 414

(4) PEDRO HERNANDEZ DB 131 PG 414

Proposed Pipe 18' x 90' Sta. 16+21

(8) CRESCENCIO & MARIA ALVAREZ DB 294 PG 249

PT Sta. 13+24.33

PI Sta 12+70.40
Δ = 12° 24' 29.9" (RT)
D = 11' 27" 33.0"
L = 108.28'
T = 54.35'
R = 500.00'

PI Sta 15+52.65
Δ = 12° 36' 35.5" (RT)
D = 28' 38" 52.4"
L = 44.02'
T = 22.10'
R = 200.00'

PC Sta. 15+30.55

PT Sta. 15+74.57

9' x 3' x 3' ID 3.D

CRESCENCIO & MARIA ALVAREZ DB 294 PG 249

WATTLES SEE SHEET '2

WATTLES SEE SHEET '4

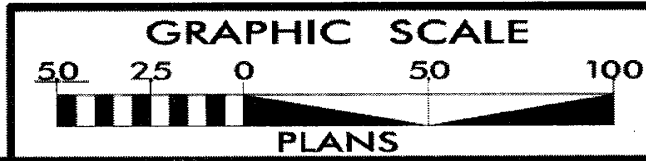

LOCATION:	SR 15th DEACON RD.
COUNTY:	ALLEGANY
TOWNSHIP:	PINEY CREEK
DESIGNED BY:	JD WOOD
CHECKED BY:	CCA DATE: CCA

REVISIONS

WATTLES MUST BE USED IN CONJUNCTION WITH PAM'S

12" MIN. WATTLE HEIGHT

ALL BASIN'S 10'-20' IN LENGTH REQUIRE 2 COIR FIBER BAFFLES. BASIN'S LESS THAN 10' REQUIRE ONLY 1

DESIGN BY: J. C. BRYANT 669

ALL CROSS LINE PIPES ARE TO BE INSTALLED IN ACCORDANCE WITH BMP 4.2

9
PEDRO HERNANDEZ
DB 131 PG 414

12
PEDRO HERNANDEZ
DB 131 PG 414

13
PEDRO HERNANDEZ
DB 131 PG 414

UNNAMED TRIBUTARY TO "NEW RIVER"

9' x 3' x 3'
ID 4.A

Proposed Pipe
18" x 40"
Sta. 19+00

Existing Property
Iron
Sta. 19+20

PC Sta. 19+86.92

Existing Property
Iron
Sta. 20+84

PT Sta. 21+03.26

Proposed Pipe
18" x 40"
Sta. 22+00

MATCHLINE SEE SHEET '3

MATCHLINE SEE SHEET '5

6.2 %

3.7 %

M 281.80.0E N

M 511.82.5E N

7.4 %

3.7 %

15' GRAVEL DRIVE
HAPPY WOODS

9' x 3' x 3'
ID 4.B

Existing Property
Iron
Sta. 21+79

11
GERVASIO A. JR. & ORESTES V.
LLORENTE
DB 292 PG 1324

10
RAYMUNDO TAMAYO
DB 293 PG 691

PI Sta 20+45.35
Δ = 13' 19" 53.7" (LT)
D = 11' 27" 33.0"
L = 116.34'
T = 58.43'
R = 500.00'

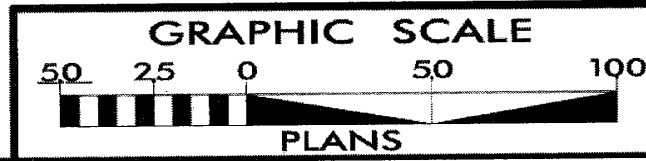

LOCATION:	SR 1317 DEACON RD.
COUNTY:	ALLEGANY
TOWNSHIP:	PINEY CREEK
DESIGNED BY:	JD WOOD
CHECKED BY:	CCA
DATE:	CCA

REVISIONS

PROJECT REFERENCE NO. SHEET NO.
 RC00303 05

PI Sta 24+64.07
 $\Delta = 103^{\circ} 56' 56.2" (RT)$
 $D = 38^{\circ} 11' 49.9"$
 $L = 272.14'$
 $T = 191.81'$
 $R = 150.00'$

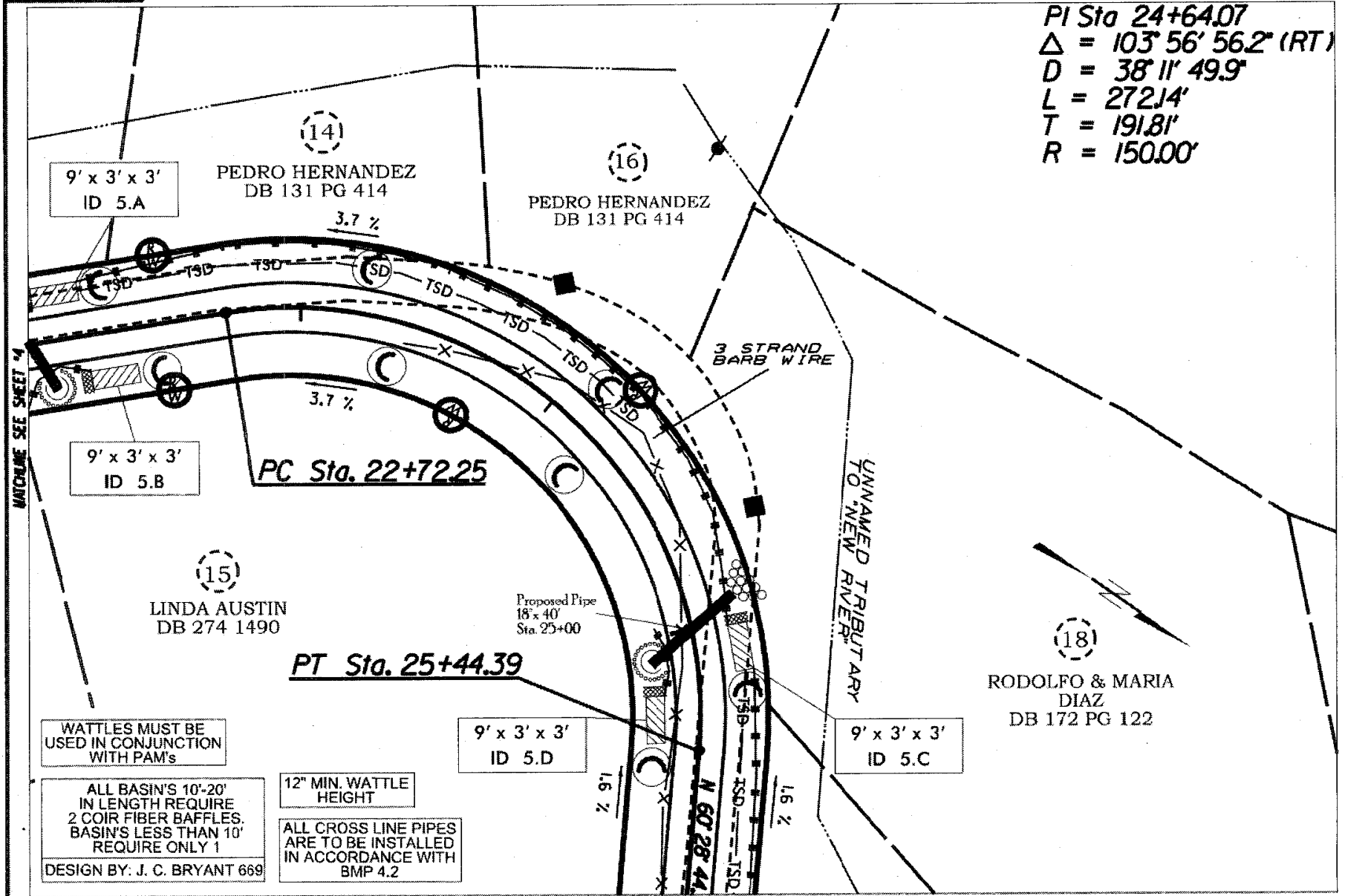

WATTLES MUST BE USED IN CONJUNCTION WITH PAM's

ALL BASIN'S 10'-20' IN LENGTH REQUIRE 2 COIR FIBER BAFFLES. BASIN'S LESS THAN 10' REQUIRE ONLY 1

DESIGN BY: J. C. BRYANT 669

12" MIN. WATTLE HEIGHT

ALL CROSS LINE PIPES ARE TO BE INSTALLED IN ACCORDANCE WITH BMP 4.2



LOCATION:	SR 15th DEACON RD.
COUNTY:	ALLEGANY
TOWNSHIP:	PINEY CREEK
DESIGNED BY:	JD WOOD
CHECKED BY:	CCA DATE: 4/08/09

MATCHLINE SEE SHEET '7'

PI Sta 32+27.06
 $\Delta = 153^{\circ} 39' 53.9" (LT)$
 $D = 57' 17" 44.8"$
 $L = 268.20'$
 $T = 427.44'$
 $R = 100.00'$

Remove existing wet pipe and repair banks with seed and coir fiber

(21)
DONALD AUSTIN
DB 274 PG 1494

Wetland Impact = 2,054 sq. ft.
Sta. 29+25 to Sta. 29+64

(19) & (20)
PEDRO HERNANDEZ
DB 131 PG 414

(15)
LINDA AUSTIN
DB 274 1490

Rip Rap should not be placed in the stream bed or below high water mark unless permitted

12" MIN. WATTLE HEIGHT

ALL CROSS LINE PIPES ARE TO BE INSTALLED IN ACCORDANCE WITH BMP 4.2

WATTLES MUST BE USED IN CONJUNCTION WITH PAM's

ALL BASIN'S 10'-20' IN LENGTH REQUIRE 2 COIR FIBER BAFFLES. BASIN'S LESS THAN 10' REQUIRE ONLY 1

DESIGN BY: J. C. BRYANT 669

PI Sta 26+91.89
 $\Delta = 15^{\circ} 53' 14.2" (LT)$
 $D = 11' 27" 33.0"$
 $L = 138.64'$
 $T = 69.77'$
 $R = 500.00'$

Proposed Pipe 18' x 40' Sta. 28+40

9' x 3' x 3' ID 6.A

Proposed Pipe 24' x 60' Sta. 28+86

3 STRAND BARS WIRE

PT Sta. 27+60.76

PC Sta. 27+99.62

PC Sta. 30+83.22
PT Sta. 30+67.82

PC Sta. 26+22.12

UNNAMED TRIBUTARY TO "NEW RIVER"

1.6 %

1.6 %

5.3 %

9-70-55' 36.2" W

N. 44° 35' 30" E

MATCHLINE SEE SHEET '5'

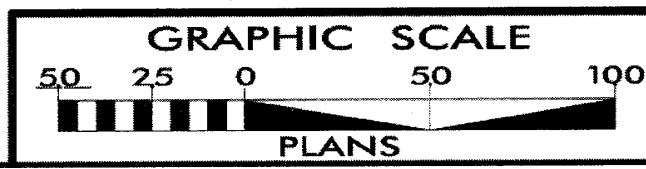

LOCATION:	SR 1311 DEACON RD.
COUNTY:	ALLEGANY
TOWNSHIP:	PINEY CREEK
DESIGNED BY:	JD WOOD
CHECKED BY:	CCA DATE: 4/08/09

ALL BASIN'S 10'-20'
IN LENGTH REQUIRE
2 COIR FIBER BAFFLES.
BASIN'S LESS THAN 10'
REQUIRE ONLY 1

DESIGN BY: J. C. BRYANT 669

WATTLES MUST BE
USED IN CONJUNCTION
WITH PAM'S

12" MIN. WATTLE
HEIGHT

(23)
PEDRO HERNANDEZ
DB 131 PG 414

(24)
PEDRO HERNANDEZ
DB 131 PG 414

(25)
JOSE R. RODRIGUEZ-ACOSTA
DB 307 PG 163

(22)
BILLY AUSTIN
DB 274 PG 1486

9' x 3' x 3'
ID 7.A

E.I.P.
33+81
17.69 LT

10' GRAVEL DRIVE
Proposed Pipe
15" x 25"
Sta. 31+65

PC Sta. 32+24.96
PT Sta. 31+95.04

PT Sta. 33+69.44

PI Sta 32+97.71
 $\Delta = 16' 33" 22.5" (RT)$
 $D = 11' 27" 33.0"$
 $L = 144.48'$
 $T = 72.75'$
 $R = 500.00'$



LOCATION:	SR 1311 DEACON RD.
COUNTY:	ALLEGANY
TOWNSHIP:	PINEY CREEK
DESIGNED BY:	JD WOOD
CHECKED BY:	CCA DATE: 4/08/09

MATCHLINE SEE SHEET #8

REVISIONS
2/12/2013

PROJECT REFERENCE NO.	SHEET NO.
RC00303	08

"DOUBLE BRANCH ROAD"

PI Sta 39+04.85
 $\Delta = 16^{\circ} 29' 03.4" (LT)$
 $D = 11' 27' 33.0"$
 $L = 143.85'$
 $T = 72.43'$
 $R = 500.00'$

ALL BASIN'S 10'-20'
 IN LENGTH REQUIRE
 2 COIR FIBER BAFFLES.
 BASIN'S LESS THAN 10'
 REQUIRE ONLY 1
 DESIGN BY: J. C. BRYANT 669

PT Sta. 39+76.28

NO CONSTRUCTION
 From Sta. 39+00 to Sta. 46+00 left;
 left of existing edge of gravel;
 (this shoulder point will be held
 to avoid impact to wetlands)

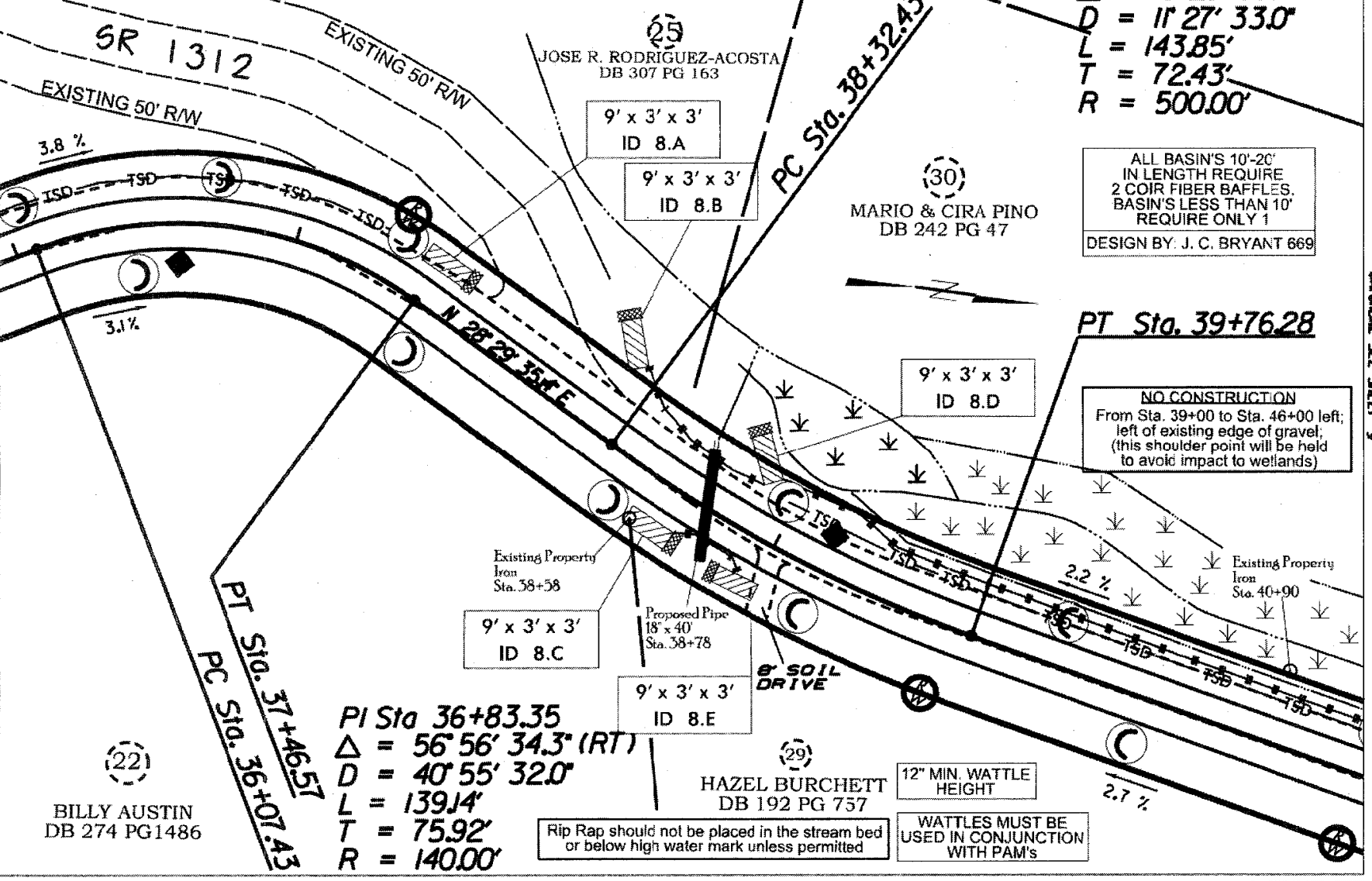

PI Sta 36+83.35
 $\Delta = 56^{\circ} 56' 34.3" (RT)$
 $D = 40' 55' 32.0"$
 $L = 139.14'$
 $T = 75.92'$
 $R = 140.00'$

Rip Rap should not be placed in the stream bed
 or below high water mark unless permitted

12" MIN. WATTLE
 HEIGHT

WATTLES MUST BE
 USED IN CONJUNCTION
 WITH PAM'S



LOCATION:	SR 1311 DEACON RD.
COUNTY:	ALLEGANY
TOWNSHIP:	PINEY CREEK
DESIGNED BY:	JD WOOD
CHECKED BY:	CCA DATE: 4/08/09

MATCHLINE SEE SHEET 7

MATCHLINE SEE SHEET 9

(Line Back) Sta. 41+92.93
(Line Ahead) Sta. 41+96.81
End Revision

NO CONSTRUCTION
From Sta. 39+00 to Sta. 46+00 left;
left of existing edge of gravel;
(this shoulder point will be held
to avoid impact to wetlands)

PT Sta. 42+33.51

(31)
MARIO & CIRA PINO
DB 242 PG 47

9' x 3' x 3'
ID 9.A

PC Sta. 43+92.65

(32)
HAZEL BURCHETT
DB 163 PB 100

(7)
PEDRO HERNANDEZ
DB 131 PG 414

NO CONSTRUCTION
From Sta. 39+00 to Sta. 46+00 left;
left of existing edge of gravel;
(this shoulder point will be held
to avoid impact to wetlands)

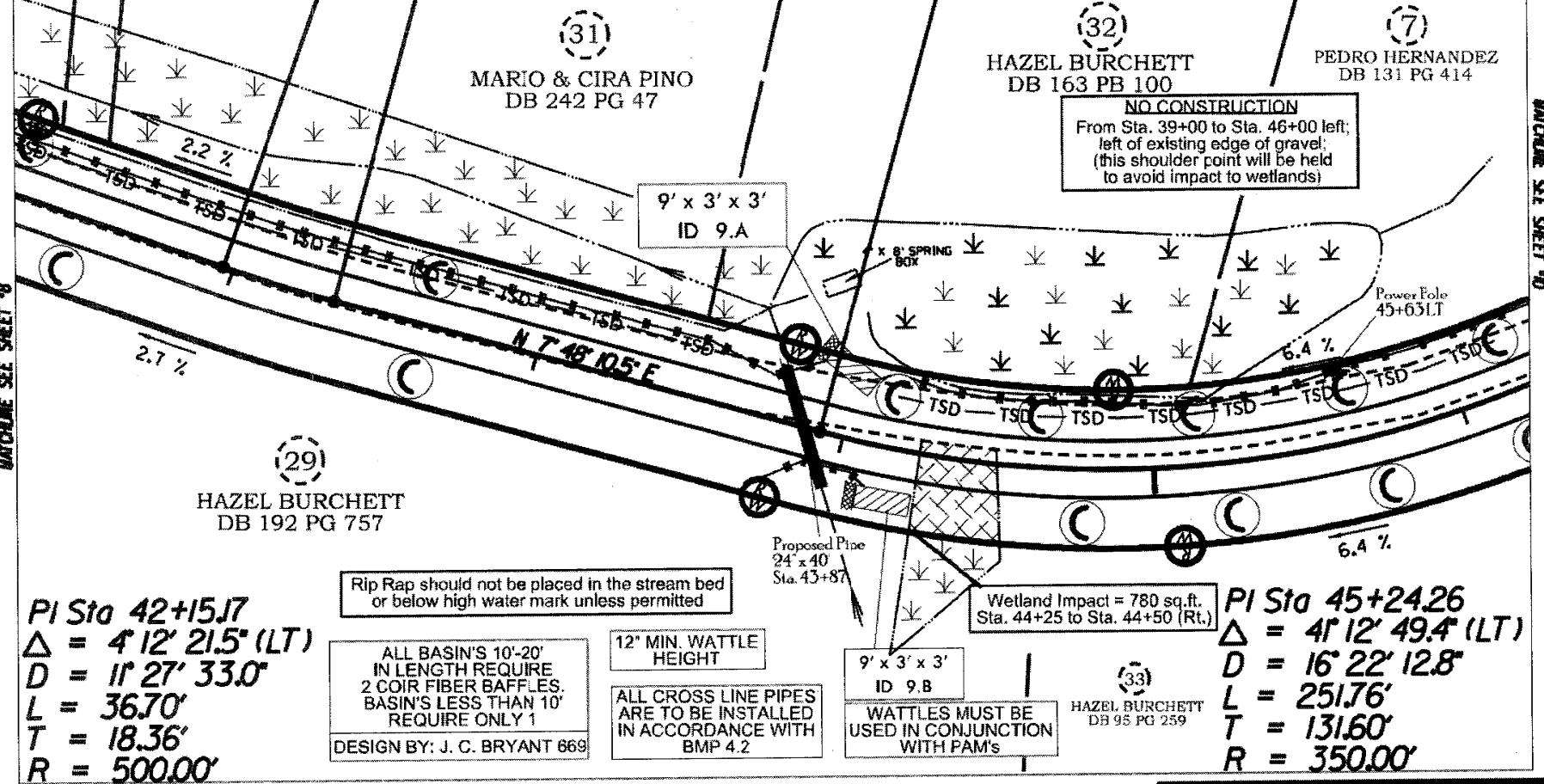

Rip Rap should not be placed in the stream bed
or below high water mark unless permitted

ALL BASIN'S 10'-20'
IN LENGTH REQUIRE
2 COIR FIBER BAFFLES.
BASIN'S LESS THAN 10'
REQUIRE ONLY 1
DESIGN BY: J. C. BRYANT 669

12" MIN. WATTLE
HEIGHT

ALL CROSS LINE PIPES
ARE TO BE INSTALLED
IN ACCORDANCE WITH
BMP 4.2

9' x 3' x 3'
ID 9.B
WATTLES MUST BE
USED IN CONJUNCTION
WITH PAM's

Wetland Impact = 780 sq.ft.
Sta. 44+25 to Sta. 44+50 (Rt.)

(33)
HAZEL BURCHETT
DB 95 PG 259

PI Sta 42+15.17
 $\Delta = 4^{\circ} 12' 21.5''$ (LT)
 $D = 11^{\circ} 27' 33.0''$
 $L = 36.70'$
 $T = 18.36'$
 $R = 500.00'$

PI Sta 45+24.26
 $\Delta = 4^{\circ} 12' 49.4''$ (LT)
 $D = 16^{\circ} 22' 12.8''$
 $L = 251.76'$
 $T = 131.60'$
 $R = 350.00'$



LOCATION:	SR 1311 DEACON RD.
COUNTY:	ALLEGHANY
TOWNSHIP:	PINEY CREEK
DESIGNED BY:	JD WOOD
CHECKED BY:	CCA DATE: 4/08/09

WATOWNE SEE SHEET '8

WATOWNE SEE SHEET '10

REVISIONS

PROJECT REFERENCE NO. SHEET NO.

R.10303

10

ALL BASIN'S 10-20'
IN LENGTH REQUIRE
2 COIR FIBER BAFFLES.
BASIN'S LESS THAN 10'
REQUIRE ONLY 1

DESIGN BY: J. C. BRYANT 669

(33)
HAZEL BURCHETT
DB 95 PG 259

POWER POLE
49+02
18.47 LT

9' x 3' x 3'
ID 10.C

12" MIN. WATTLE
HEIGHT

WATTLES MUST BE
USED IN CONJUNCTION
WITH PAM's

9' x 3' x 3'
ID 10.A

Proposed Pipe
18' x 40'
Sta. 47+00

Proposed Pipe
18' x 40'
Sta. 50+00

9' x 3' x 3'
ID 10.B

9' x 3' x 3'
ID 10.D

(33)
HAZEL BURCHETT
DB 95 PG 259

PT Sta. 46+44.41
MATCHLINE SEE SHEET '09

MATCHLINE SEE SHEET '10

PC Sta. 47+37.36

PT Sta. 50+93.57

PI Sta 49+39.83
Δ = 68° 01' 49.8" (RT)
D = 19° 05' 54.9"
L = 356.21'
T = 202.47'
R = 300.00'



LOCATION:	SR 1311 "DEACON RD."
COUNTY:	ALLEGHANY
TOWNSHIP:	PINEY CREEK
DESIGNED BY:	JD WOOD
CHECKED BY:	CCA
DATE:	4/08/09

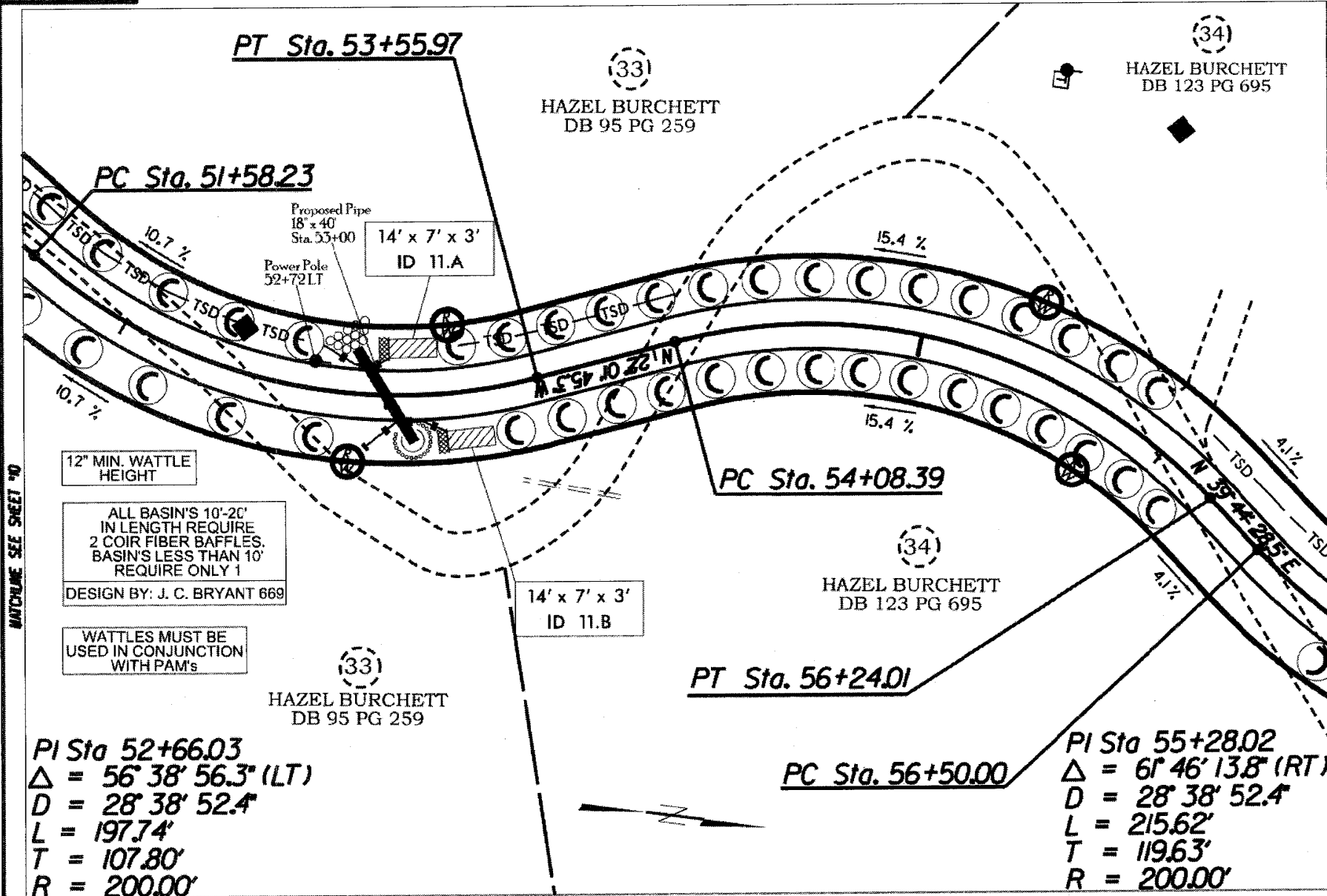

12" MIN. WATTLE HEIGHT

ALL BASIN'S 10'-20' IN LENGTH REQUIRE 2 COIR FIBER BAFFLES. BASIN'S LESS THAN 10' REQUIRE ONLY 1
DESIGN BY: J. C. BRYANT 669

WATTLES MUST BE USED IN CONJUNCTION WITH PAM's

(33)
HAZEL BURCHETT
DB 95 PG 259

14' x 7' x 3'
ID 11.B

(34)
HAZEL BURCHETT
DB 123 PG 695

PI Sta 52+66.03
 $\Delta = 56^{\circ} 38' 56.3" (LT)$
 $D = 28^{\circ} 38' 52.4"$
 $L = 197.74'$
 $T = 107.80'$
 $R = 200.00'$

PI Sta 55+28.02
 $\Delta = 61^{\circ} 46' 13.8" (RT)$
 $D = 28^{\circ} 38' 52.4"$
 $L = 215.62'$
 $T = 119.63'$
 $R = 200.00'$



LOCATION:	SR 131 "DEACON RD."
COUNTY:	ALLEGHANY
TOWNSHIP:	PINEY CREEK
DESIGNED BY:	JD WOOD
CHECKED BY:	CCA
DATE:	4/08/09

ALL BASIN'S 10'-20'
IN LENGTH REQUIRE
2 COIR FIBER BAFFLES.
BASIN'S LESS THAN 10'
REQUIRE ONLY 1

DESIGN BY: J. C. BRYANT 669

12" MIN. WATTLE
HEIGHT

WATTLES MUST BE
USED IN CONJUNCTION
WITH PAM'S

END PROJECT
60+50.68
VIRGINIA STATE
LINE

PT Sta. 59+47.4

9' x 3' x 3'
ID 12.D

(34)

HAZEL BURCHETT
DB 123 PG 695

9' x 3' x 3'
ID 12.A

PT Sta. 60+92.8

POT Sta. 61+18.83

9' x 3' x 3'
ID 12.C

PT Sta. 60+70.83

9' x 3' x 3'
ID 12.B

Proposed Pipe
18' x 40'
Sta. 58+00

PC Sta. 59+79.03

(34)

HAZEL BURCHETT
DB 123 PG 695

North Carolina - Alleghany County
Virginia - Grayson County

PI Sta 58+33.67
 $\Delta = 85^{\circ} 07' 36.6"$ (LT)
 $D = 28^{\circ} 38' 52.4"$
 $L = 297.15'$
 $T = 183.67'$
 $R = 200.00'$

PI Sta 60+27.11
 $\Delta = 42^{\circ} 04' 46.4"$ (RT)
 $D = 45^{\circ} 50' 11.8"$
 $L = 91.80'$
 $T = 48.08'$
 $R = 125.00'$

MATCHLINE SEE SHEET "11"

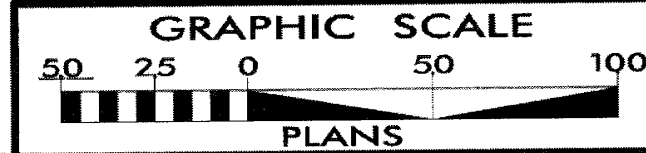

LOCATION:	SR 1311 'DEACON RD.'
COUNTY:	ALLEGHANY
TOWNSHIP:	PINEY CREEK
DESIGNED BY:	JD WOOD
CHECKED BY:	CCA
DATE:	4/08/09

FENCE LINE DATA SHEET

ROAD NAME :SR 1310 "DEACON RD."

STATION	STATION	RT. / LT.	FUNC. / NONFUNC. FUNCTION	TYPE OF FENCE
23+40	33+10	RT.	FUNCTION	3 STRAND BARB WIRE
60+54	60+57	LT.	FUNCTION	4 STRAND BARB WIRE

<u>Std. #</u>	<u>Description</u>	<u>Symbol</u>
1605.01	Temporary Silt Fence	
1606.01	Special Sediment Control Fence	
1622.01	Temporary Berms and Slope Drains	
1630.02	Silt Basin Type B	
1630.03	Temporary Silt Ditch	
1630.05	Temporary Diversion	
1630.06	Special Stilling Basin	
1632.03	Rock Inlet Sediment Trap Type C	
1633.01	Temporary Rock Silt Check Type-A	
	Temporary Rock Silt Check Type-A with Matting and Polyacrylamide (PAM)	
	Temporary Rock Silt Check Type-B	
	Wattle	
	Infiltration Basin	
	Wattle with Polyacrylamide (PAM)	
1634.02	Temporary Rock Sediment Dam Type-B	
1635.01	Rock Pipe Inlet Sediment Trap Type-A	

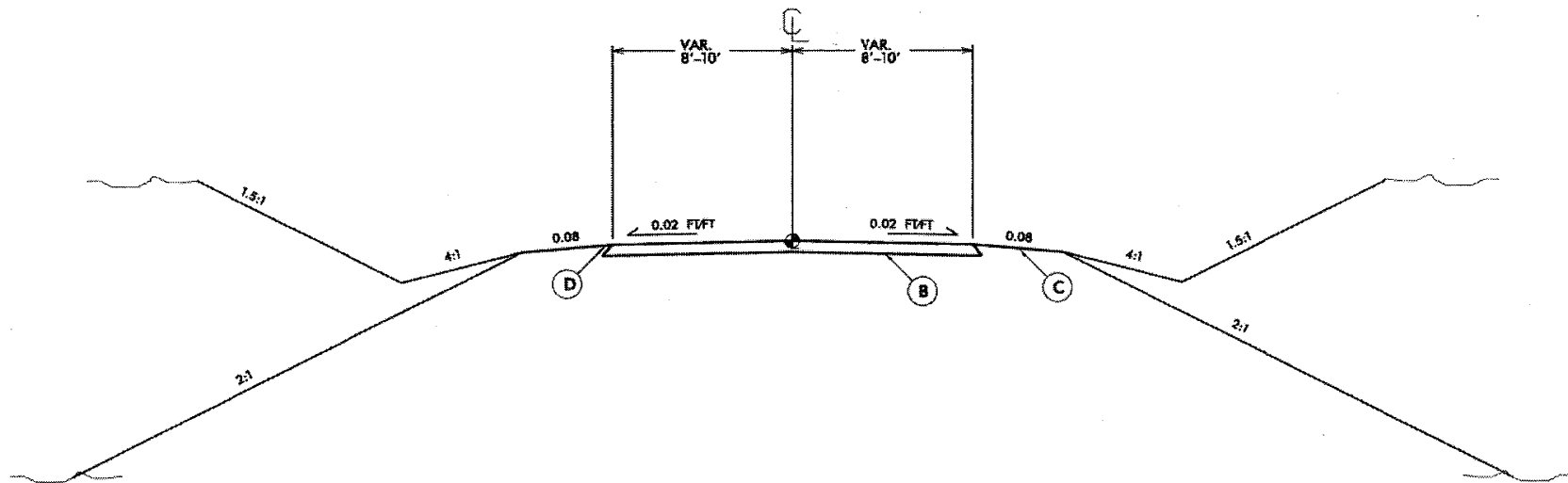

B 8" (compacted) ABC

C Shoulder varies: Cut side = 4' shoulder on .08 ft/ft
 transition to a 4:1 slope for a distance of 4'
 to center of the ditch line
 Fill side = 6' to shoulder break

D Base should be 1' wider than
 overall proposed road width